

DISCHARGING

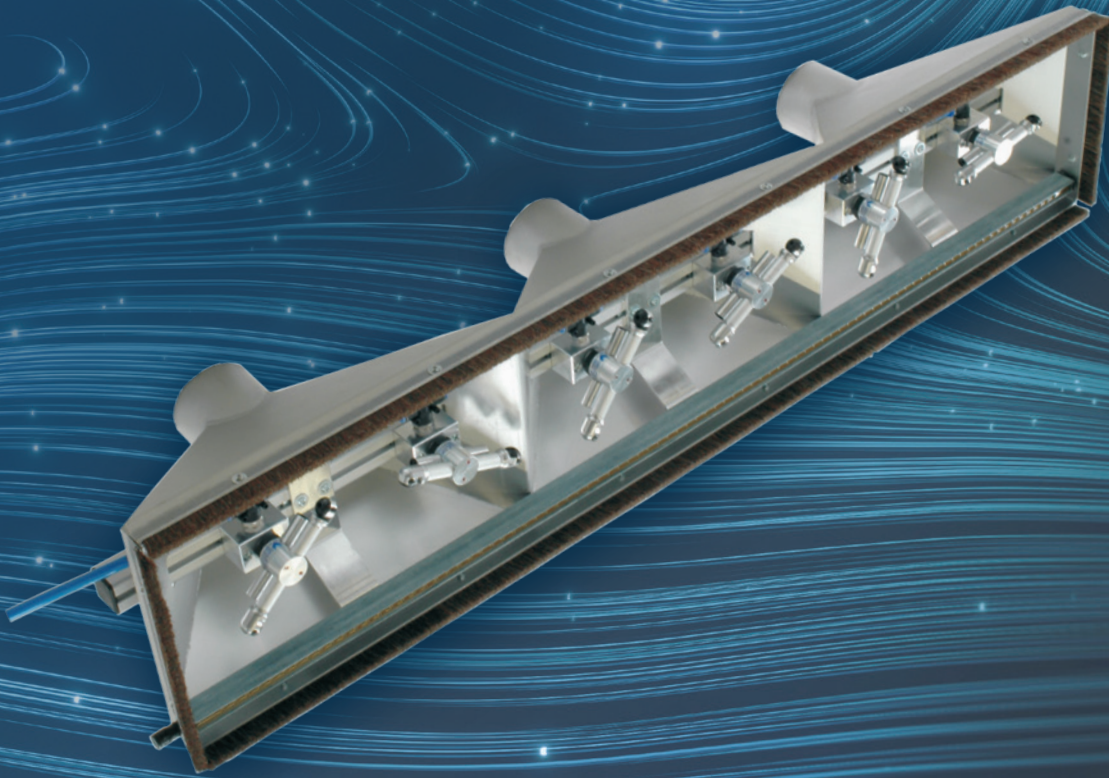

**eltex**

electrostatic  
innovations

## > Static Combi Cleaner SCC

### Cleaning unit with rotating ion blower nozzles

The combination of Eltex ionizing bars and speed-controlled, pressure-independent rotating nozzles with pulsating effect achieves maximum cleanliness on smooth, structured and three-dimensional surfaces.

#### Advantages at a glance

- > non-contacting cleaning
- > highly effective electrostatic discharge of surfaces and particles
- > Depth effect with structured and 3D-surfaces
- > pressure-independent control of the rotating nozzles
- > in combination with the POWER IONIZER also suitable for ESD applications

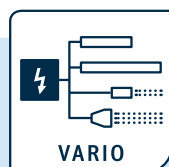

Suitable for connecting  
one or more Eltex  
discharge components:



PRO IONIZER ES61



BASE IONIZER ES60



COMPACT IONIZER ES24

## Static Combi Cleaner SCC

### Functional principle

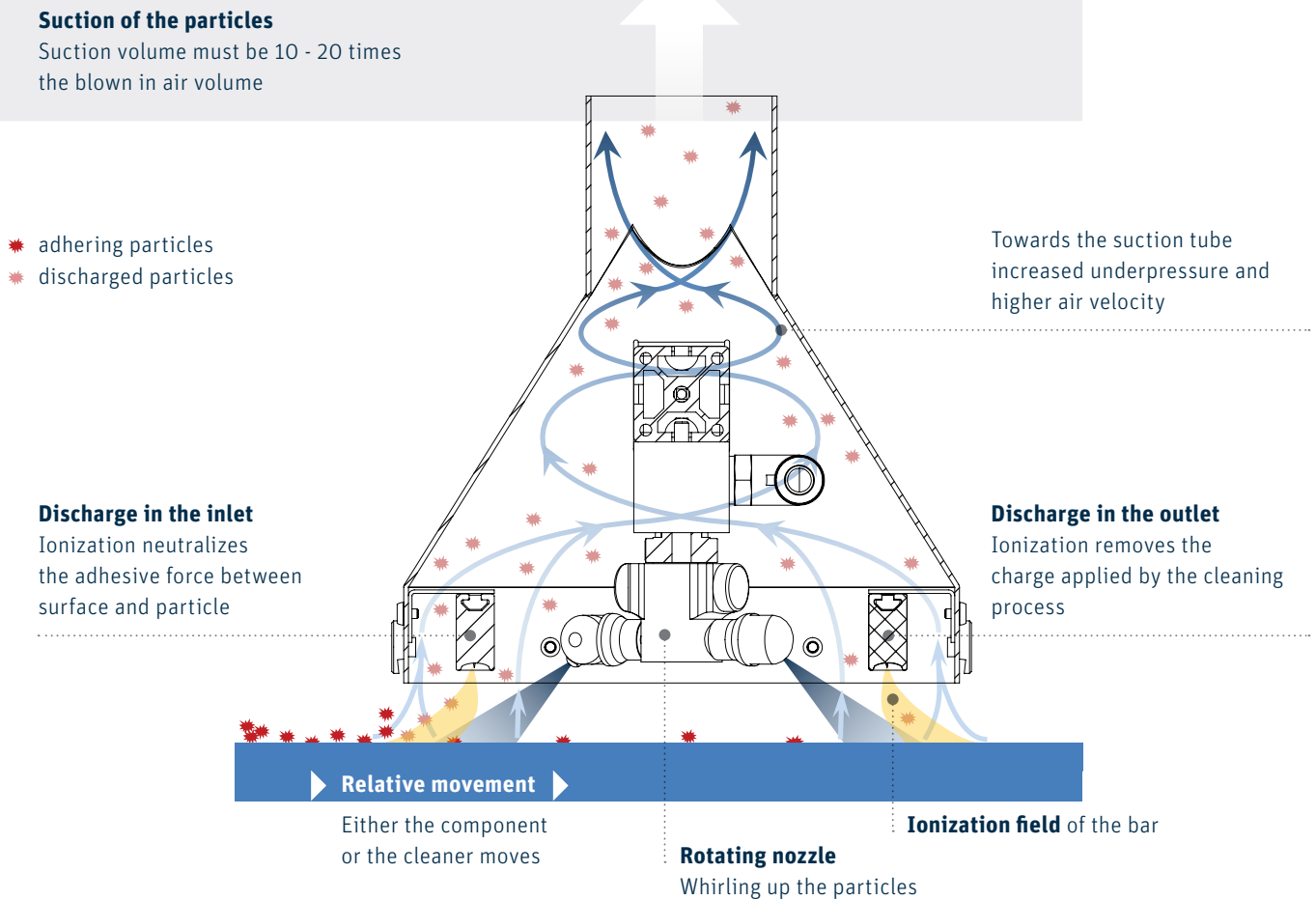

### Technical information

Weight	without suction hood	approx. 9 kg/m							
	with suction hood	approx. 12 kg/m							
Required air pressure	2,5 – 10 bar, dry, oil-free, filtered – Filter fineness < 20µm								
Air consumption per nozzle (speed controlled, 6 bar)	Ø-nozzle insert mm	0.6	0.8	1.0	1.2	1.4	1.6	1.8	2.0
	NI/min.	79	101	150	201	246	313	392	484
Nozzle speed controlled nozzle	approx. 600 U/min								
Compressed air connection	G 1/2", or hose grommet NW13								
Required suction power (option suction enclosure)	min. 600 m3/h per suction nozzle, vacuum pressure min. 2500 Pa (-0,025 bar)								
Operating ambient temp.	0 ... 80 °C, max. 70 % RH, non dewing								
Speed sensor	option								
<b>Following Standards are fulfilled</b>	ANSI-ESD-STM3.1, RCJS-TR-5-4, JIS C 61340-4-7, IEC 61340-4-7 ED.2 Ionbalance*								

\* In connection with the PRO IONIZER ES61 power supply and defined parameters

**Static Combi Cleaner SCC**

Dimensions without suction hood

Main dimensions (L x W x H)  
EL mm x EB mm x 200 mm

EL = Installation length  
AB = Working width  
WD = effective nozzle diameter  
EB = Installation width

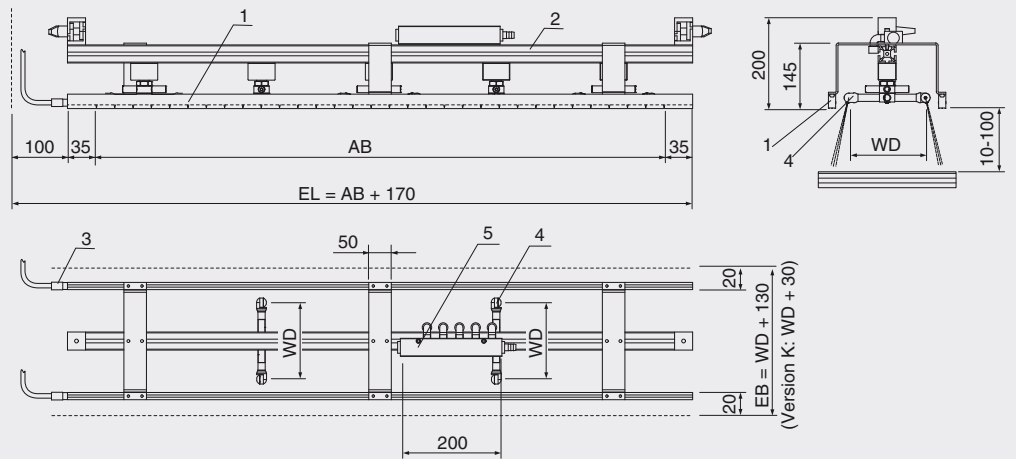

Dimensions with suction hood

Main dimensions (L x W x H)  
EL mm x 300 mm x 316 mm

EL = Installation length  
AB = Working width  
WD = Effective nozzle diameter

